

FJH35 Series

Hall Effect Joystick

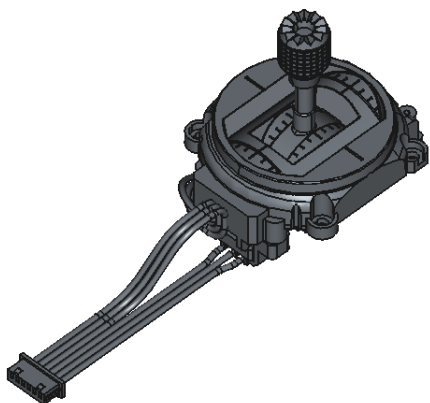

Feature:

1. Exceptionally Long Lifespan
2. High Precision
3. Pleasant Tactile Feel

Application:

- Game Controller
- Drone Controller
- Handheld Gimbal

Mechanical Characteristics

Operation Angle of Lever	30° per side
Operation Force of Lever	50±40gf
Accuracy of Reset Position of Lever	0.7±0.35N

Endurance Characteristics

Number of Cycles	5,000,000 cycles
------------------	------------------

Electrical Characteristics

Voltage Divider Error	40~60%
Accuracy of Reset Position of Voltage Divider Error	Less than 5.5%
Insulation Resistance	More than 100 MΩ
Withstand Voltage	AC 250V

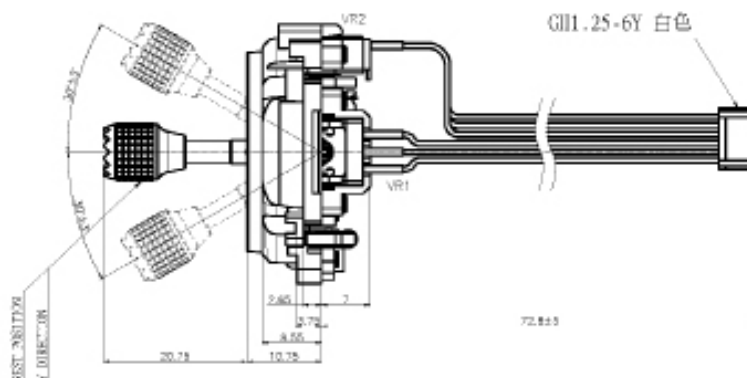
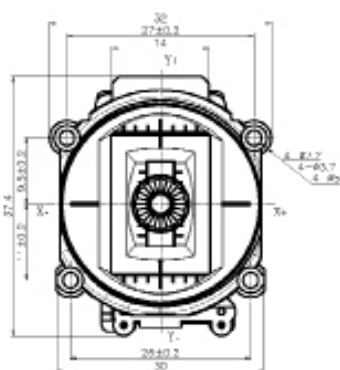

全数検査項目 (100%)	±0.3
100%	±0.5
100%以上	±0.8
内 度	±0.1

1: (白色)
2: (黑色)
3: (黄色)
4: (蓝色)
5: (绿色)
6: (白色)

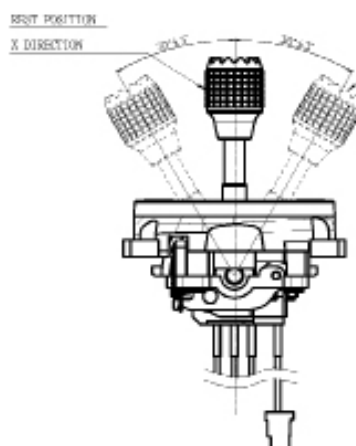

我司手柄参考(客户可自配套)
手柄齿配内牙M2*0.25,深度3.3mm以上.

Pin definition (Pin 脚定义)



1: (红色) — VDD
2: (黑色) — AD2
3: (黄色) — GND
4: (蓝色) — VDD
5: (绿色) — AD1
6: (白色) — GND

SCALE: 4/1